

# McCain Walls™ Optional Wall System Components

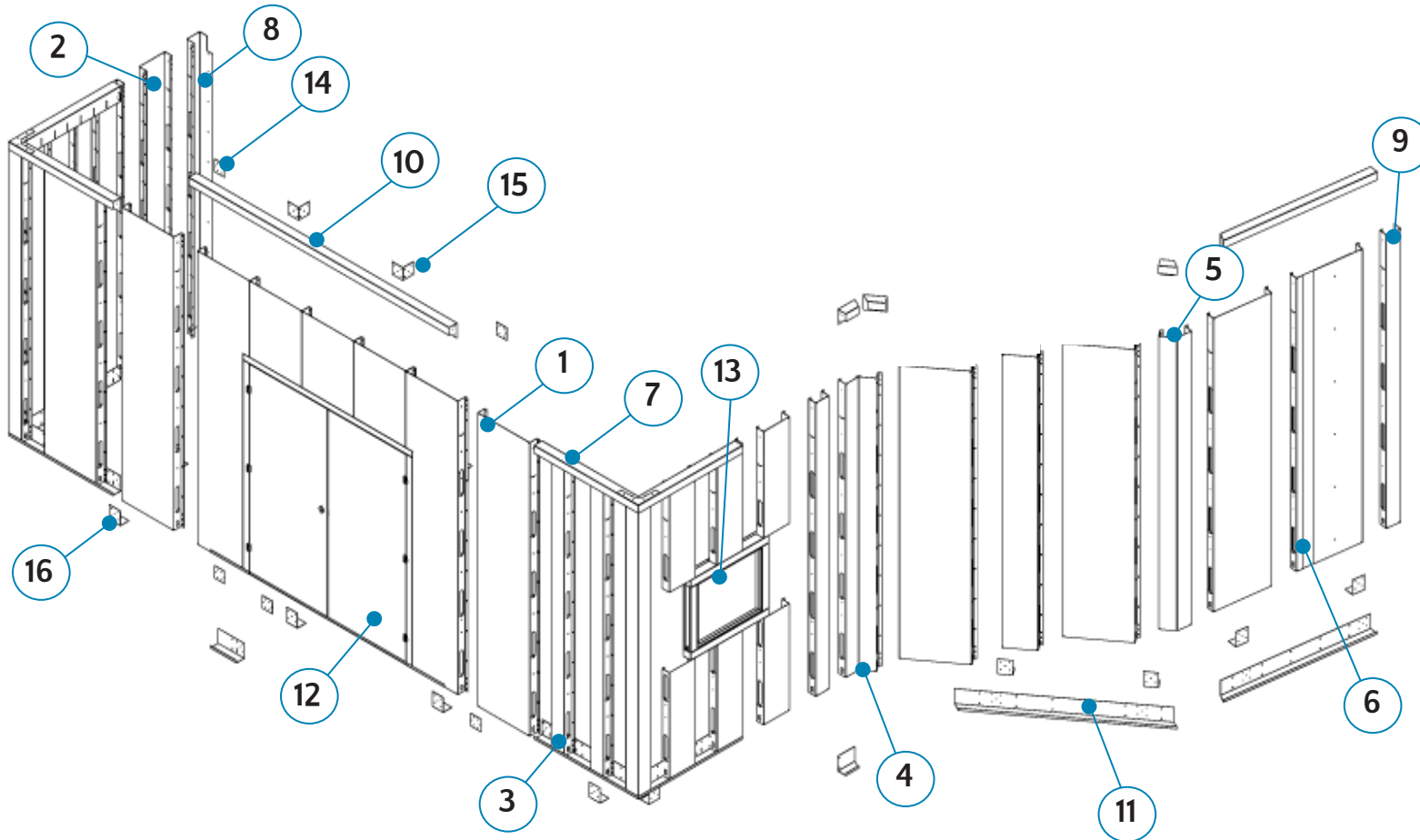

McCain Walls™ modular temporary wall systems are customizable and reconfigurable to meet any job spec. Optional components are available to enhance wall panel heights up to 14' without stacking, and increase lengths of a wall panel to close small gaps. Options for corners less than or more than 90 degrees and door kits are also available. All McCain Wall system components are manufactured from 0.09 THK aluminum and are available in white powder coat gloss finish.



## COMPONENTS LIST

- 1 - Wall Panel (120" x 24")
- 2 - Wall Panel (120" x 12")
- 3 - Wall Panel (120" x 6")
- 4 - Variable Inside Angle Panel
- 5 - Variable Outside Angle Panel
- 6 - Adjustable Sliding Panel
- 7 - Outside Corner Kit
- 8 - Starter Left Panel
- 9 - Starter Right Panel
- 10 - Top Rail
- 11 - Bottom Rail
- 12 - Double Door
- 13 - Window Frame
- 14 - Splice Bracket
- 15 - Bracing Plate
- 16 - Anchor Mount

### Contact Us

For a quote, to place an order, or learn more give us a call at (760) 295-9230 or visit [www.mccainwalls.com](http://www.mccainwalls.com)

\*Dimensions are rounded to the nearest inch. Patent Pending.

2633 PROGRESS STREET | VISTA, CALIFORNIA 92081 | USA | [WWW.MCCAINWALLS.COM](http://WWW.MCCAINWALLS.COM)

© 2017 McCain Manufacturing, Inc. Updated 07/12/17. McCain Manufacturing reserves the right to change product specifications without notice. For the most up-to-date information, please contact McCain Manufacturing.